



**FOR MEN**



**I-TRIM & SHAVE  
BEARD TRIMMER & DUAL FOIL SHAVER**

Model VSM890A



## **I-TRIM & SHAVE**

### **PRODUCT FEATURES**

- Trimmer blades: W-Tech - stainless steel
- 1 cutting guide for 21 lengths (from 0.5 mm to 10.5 mm, in 0.5 mm increments)
- Dual shaving head with nickel foils
- 3-position switch: trimmer/off/shaver
- Grooved wheel to adjust the cutting length
- Accessories : adaptor, cleaning brush, protective cap, oil
- Waterproof

### **IMPORTANT INFORMATION REGARDING**

#### **THE NI-MH BATTER IES OF THIS UNIT**

To obtain and maintain the longest battery autonomy possible, allow it to charge for 16 hours before using it for the first time and then approximately every three months. Full autonomy of the unit will only be obtained after three complete recharge cycles.

#### **CHARGING THE APPLIANCE**

1. Plug the cord into the appliance and connect the transformer. Before using the appliance for the first time, allow it to charge for 16 hours. Make sure the appliance's switch is in the OFF position.
2. Check that the charging indicator light is lit.
3. A full charge provides a minimum of 45 minutes' use of the appliance.
4. Subsequent charges should also be 16 hours.

## USE ON THE MAINS

To use the appliance on the mains, plug the cord into the unit. Plug the appliance, in the OFF position, into the mains, then switch it on (if the battery is very weak, wait about 1 minute).

**IMPORTANT!** Use only the adapter that is supplied with the appliance.

## USING THE TRIMMER

It is recommended to put the protective cap on the shaver head before using the trimmer head.

**NOTE:** Always put the comb guide on **BEFORE** turning the trimmer on, and turn the trimmer off before removing it.

To remove or replace the comb guide, turn off the appliance, pull the guide up to remove it, press the guide down then turn the dial to put it on.

To adjust the cutting length of the appliance, turn the dial.

Activate trimmer mode (picture 1).

You can change the cutting length at any time.

**NOTE! Make sure you hold the comb flat against the skin in order to guarantee an even cut.**

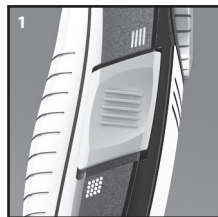

## USING THE SHAVER

For greater comfort, set the trimmer head's cutting guide to the lowest position before using the shaver head.

Activate shaver mode (picture 2).

Stretch the skin of the area you wish to shave and move the shaver head over it, against the direction of your hair growth.

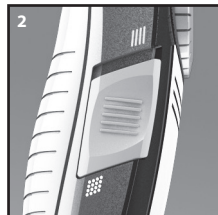

## WATERPROOF

For a greater comfort of use, your appliance is waterproof and can even be used in the shower. Easy to clean, it guarantees maximum hygiene.

- **WARNING:** Unplug the appliance before using or cleaning it in water.
- The adaptor must be placed so it cannot fall into water.

## MAINTENANCE

Regular maintenance of the appliance's blades will keep them in optimal working condition.

### Removable blades (trimmer)

To make cleaning easier, the VS For Men trimmer blades can be removed. Make sure the appliance is turned off and then remove the comb guide. Hold the trimmer with the blades facing up and remove them by pressing on the tips of the blades (picture 3).

Carefully brush the blades using the cleaning brush to remove hair.

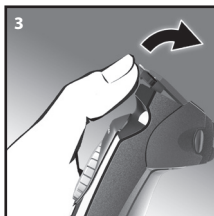

### Self-lubricating blades (trimmer)

The blades of your trimmer have a reservoir pad for releasing the necessary amount of oil for proper operation of your trimmer, time after time. Nevertheless, it is recommended that it be refilled occasionally when you notice performance is not as high. Remove the blades as described above. Squeeze a few drops of VS For Men oil onto the pad (picture 4). Then replace the blades on the trimmer.

The VS For Men oil is specially formulated for the trimmer, it does not evaporate nor does it slow the blades. It is possible to obtain replacement blades when these are worn out or damaged, please contact Conair Customer Service on 1800 650 263 for spare parts.

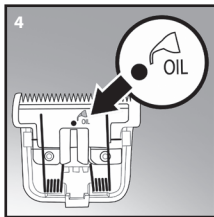

## Removable foil (shaver)

To make cleaning easier, the foil of the shaver head is removable.

To remove it, press the fasteners on its sides (picture 5) using your thumb and your index and lift it up.

Remove remaining hair using the cleaning brush.

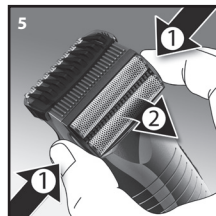

## Washable

For maximum hygiene, the heads of the appliance can be washed in water. Move the comb guide away from the body of the unit slightly, remove the foil from the shaver head, then rinse the heads of the appliance under running water. The comb guide and the foil can also be rinsed separately.



## SAFE DISPOSAL

To minimise hazards to health and the environment at the end of this product's life, laws dealing with Waste Electrical and Electronic Equipment (WEEE) and The Waste Battery Directive require you to dispose of this product at a suitable collection facility where it will be sent for appropriate recycling. Please contact your local authorities for more details on recycling and safe disposal of these in your area.

### SAFETY CAUTIONS

**WARNING!** Polythene bags over the product or packaging may be dangerous. To avoid danger of suffocation, keep away from babies and children. These bags are not toys.

- Do not use or leave the appliance where it can become wet or where there is a danger of it falling into basins or other vessels containing water.
- This appliance should only be used as described within this instruction book. Please retain for reference.

- Do not connect the appliance to the mains with wet hands.
- Always inspect the appliance before use for noticeable signs of damage. Do not use if damaged, or if the appliance has been dropped.
- Do not use the appliance if the lead is damaged.
- Only use the adaptor and attachments supplied with this appliance.
- Always unplug the appliance when fully charged.
- Do not leave the appliance unattended when switched on.
- Do not place the appliance on any surface whilst in operation.
- This appliance should not be used by adults or children whose lack of experience, product knowledge or disability might cause a hazard, unless they have been correctly instructed and are adequately supervised.
- Children should always be supervised to ensure that they do not play with this product.
- Special care is required when using the appliance close to the ears, eyes and face.
- Always switch off and unplug the appliance when cleaning or when not in use.
- Allow the appliance to cool before storing away.
- After use, do not coil the cord around the appliance as this may cause damage to the cord. Instead, coil the cord loosely by the side of the appliance.
- This appliance complies with the requirements of Directives 2004/108/EC (Electromagnetic Compatibility) and 2006/95/EC (Electrical Safety of Domestic Appliances).
- This appliance contains Ni-MH batteries. To protect the environment this appliance and its batteries must be disposed of safely. At the end of its life, please take this appliance to a recycling centre.
- If the battery is leaking do not touch it and take it to a recycling centre.

## **LIMITED TWO -YEAR WARRANTY**

This product is subject to the express warranty given on the warranty card included with the product, as may be amended by reference to and in accordance with the terms of the warranty cards displayed on VS For Men website [www.vsformen.com.au](http://www.vsformen.com.au)

To make a warranty claim you must retain your proof of purchase. Further details can be found at [www.vsformen.com.au](http://www.vsformen.com.au) and click on 'customer service'.

Vidal Sassoon and related logos are trademarks of  
The Procter & Gamble Company used under license by Conair



©2014

Conair Australia Pty. Ltd.  
Suite 101, 18 Rodborough Rd  
Frenchs Forest NSW, 2086  
Australia

Customer Service Hotline (Australia): 1800 650 263  
Customer Service e-mail: [aus\\_info@conair.com](mailto:aus_info@conair.com)

Conair New Zealand Limited, PO BOX 251159, Pakuranga, Auckland  
1706 New Zealand  
Customer Service Hotline (New Zealand): 0800 266 247